

Key

==== Double Yellow Lines

Botany Close junction St Georges Avenue,  
Sheppey - Double Yellow Lines

DRAWN	BOC
DATE	Apr 10
SCALE	N.T.S

ES/2738/57



Halley's Stationery Office Ltd. Design copyright, trademark and reproduction rights reserved. All rights reserved. No part of this publication may be reproduced, stored in a retrieval system or transmitted in any form or by any means, electronic, mechanical, photocopying, recording or otherwise, without the prior written permission of Halley's Stationery Office Ltd. Swale Borough Council, LA87950X, 2011





**Key**  
 Double Yellow Lines

Junctions off Main Road, Queenborough -  
 Double Yellow Lines

<b>DRAWN</b>	<b>BOC</b>
<b>DATE</b>	<b>Apr 10</b>
<b>SCALE</b>	<b>N.T.S</b>

ES/2738/55



Her Majesty's Stationery Office © Crown copyright. Unauthorised reproduction or use of this information may lead to prosecution. Swale Borough Council, Ludlowick, 2001

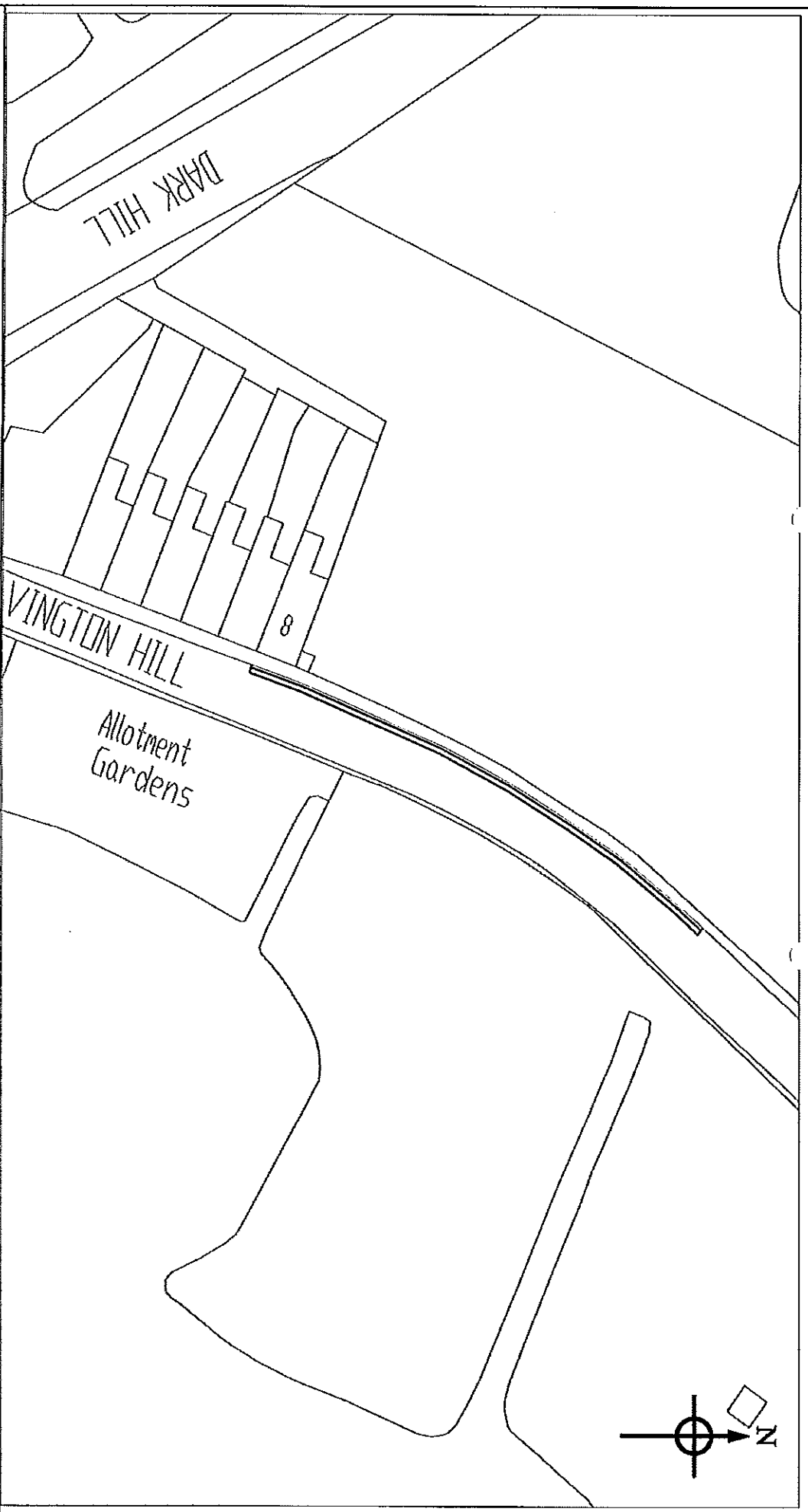

Key

==== Proposed Double Yellow Lines

Davington Hill, Faversham - Proposed Double Yellow Lines.

DRAWN	BOC
DATE	April 10
SCALE	1:500

ES/2738/45

No part of this document is to be reproduced, stored in a retrieval system, or transmitted in any form or by any means, electronic, mechanical, photocopying, recording, or by any information storage and retrieval system, without the prior written permission of Swale Borough Council, 14079256, 2011



Lydbrook Close junction London Road, Sittingbourne - Proposed Double Yellow Lines

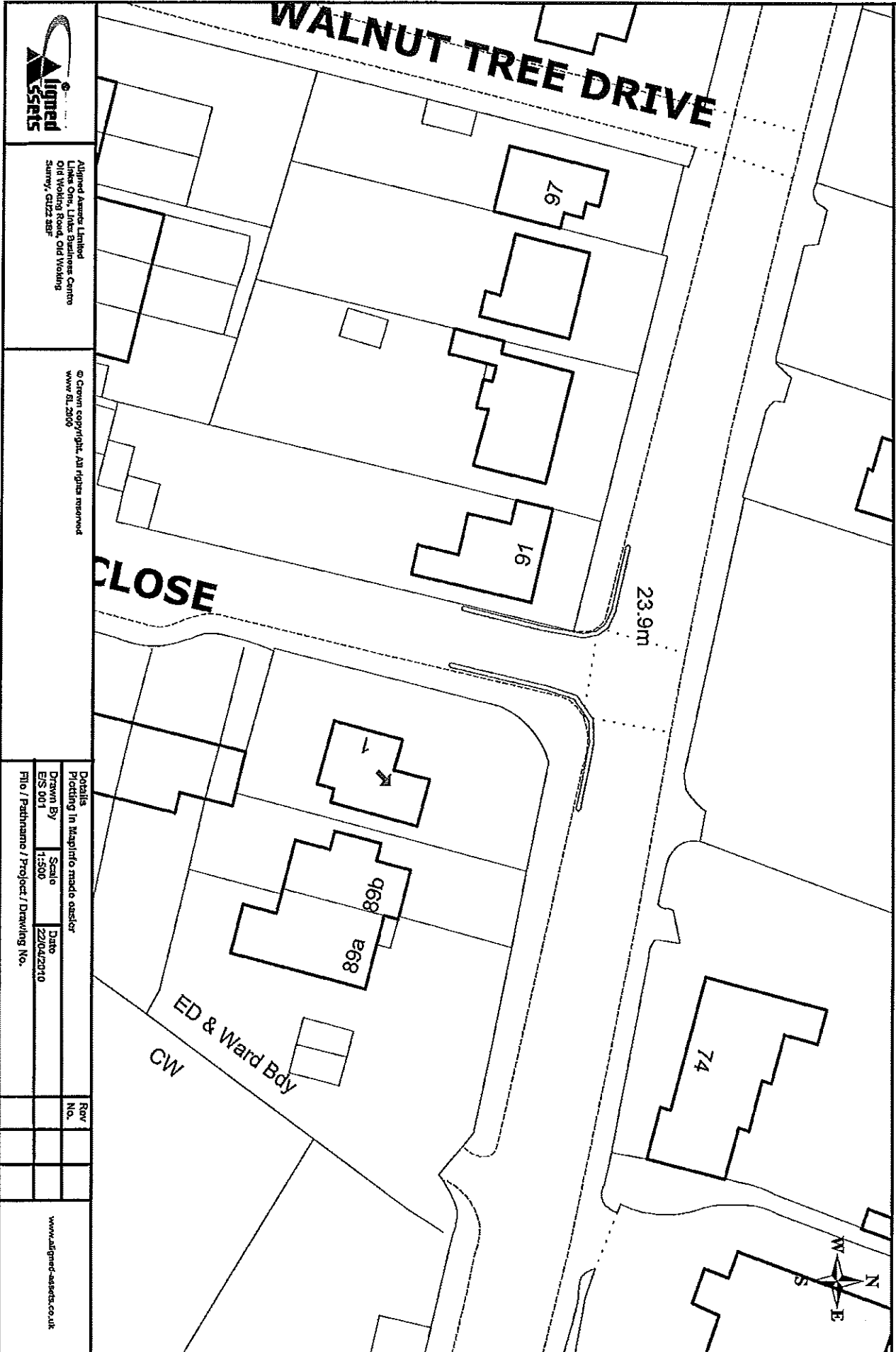

Alligned Assets Limited  
 Lydbrook, The Station Centre  
 Old Washing, Old Washing  
 Sitting, G22Z 8EP

© Crown copyright. All rights reserved  
 www.sls.gov.uk

Details		Rev
Drawn By	Scale	
ES 001	1:500	
Date	22/04/2010	
File / Pathname / Project / Drawing No.		

www.alligned-assets.co.uk

# ANNEX A

## High Street Junction Central Avenue, Sittingbourne - Proposed Double Yellow Lines

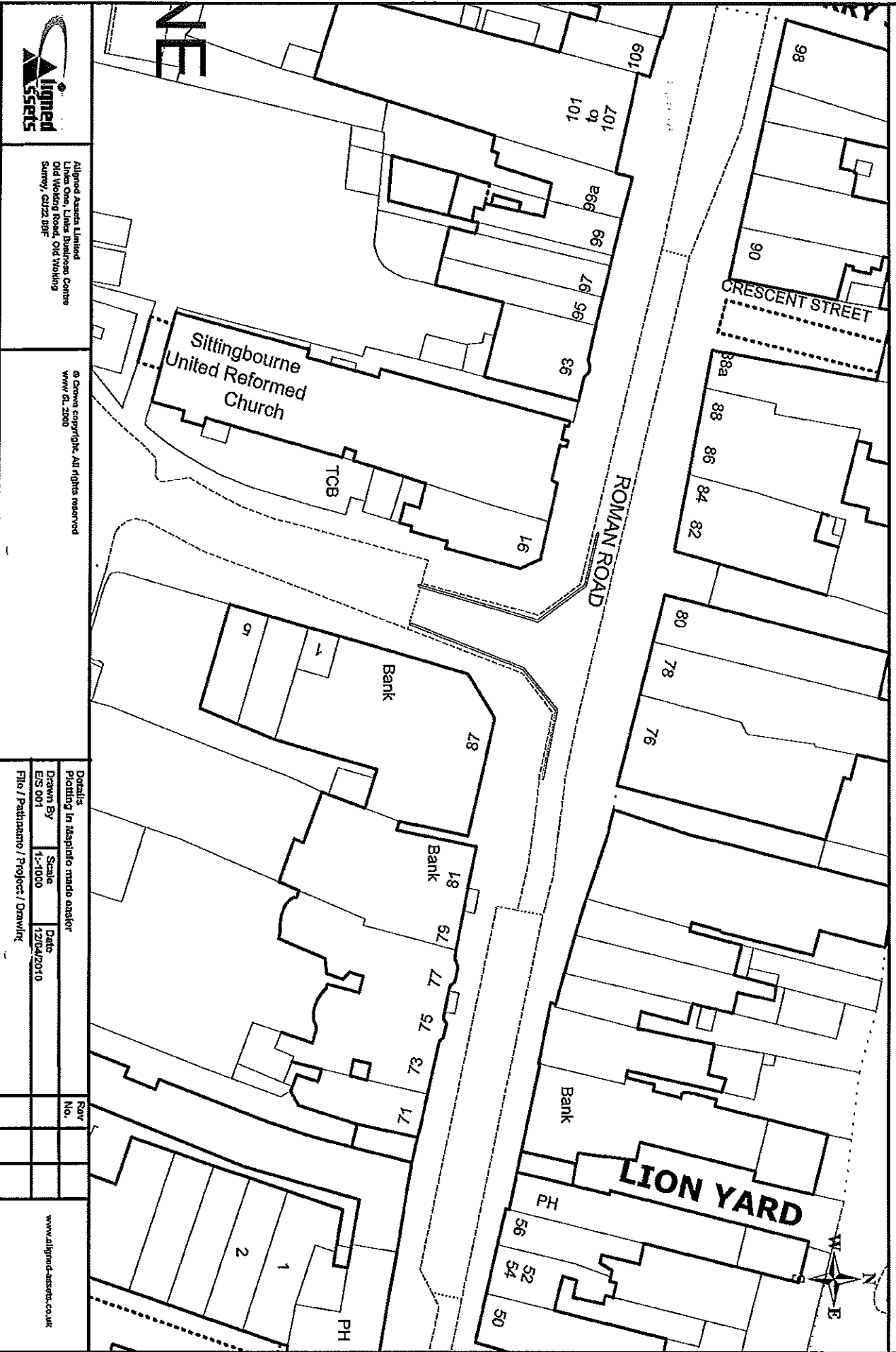

Alligned Assets Limited  
 The Old Law Library Centre  
 Old Mission Road, Old Woking  
 Surrey, GU24 8JF

© Crown copyright. All rights reserved  
 www.02.2000

Tavistock Close Junction Johnson Road, Sittingbourne - Proposed Double Yellow Lines

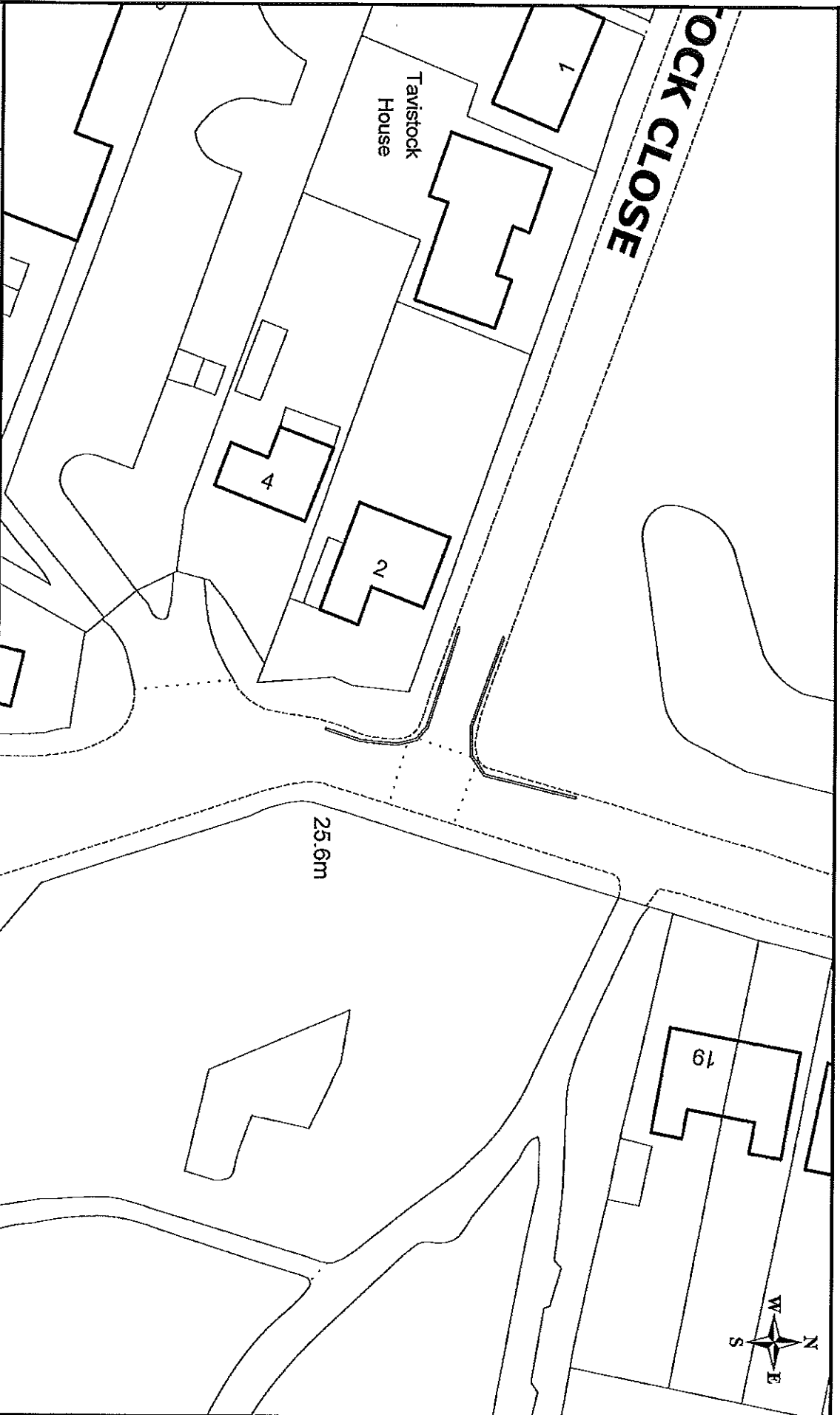

Aligned Assets Limited  
Units One, Limes Business Centre  
Old Woking Road, Old Woking  
Surrey, GU24 8BP

© Crown copyright. All rights reserved  
www.dl.gov

Details  
Plotting in Microsoft made outside

Drawn By	Scale	Date
ES: DM	1:500	12/04/2010

Rev  
No.

www.aligned-assets.co.uk

ANNEX A

Barrow Grove Junction Homewood Avenue, Sittingbourne - Proposed Double Yellow Lines

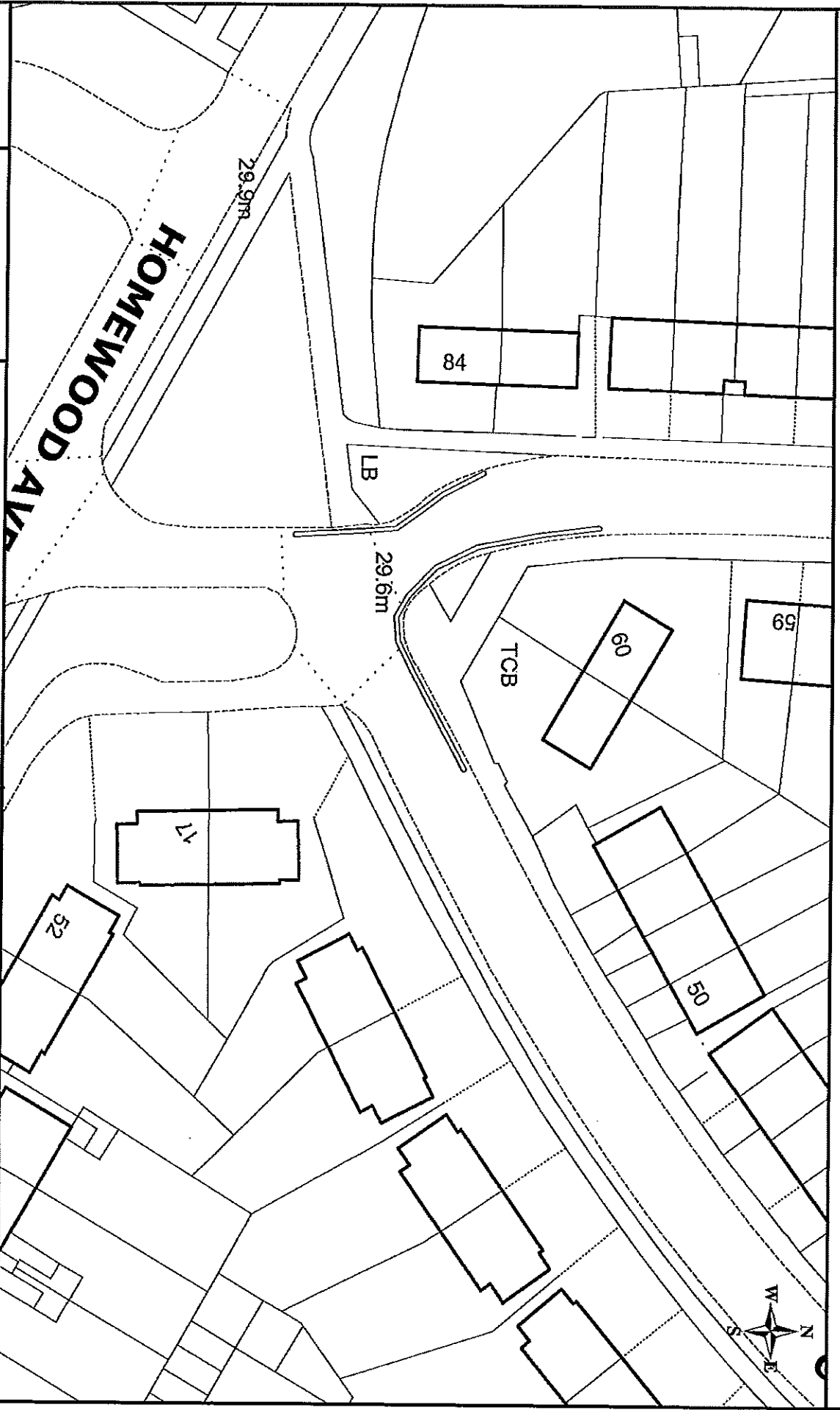

Alligned Assets Limited  
 Units One, Limes Business Centre  
 Old Meeting Road, Old Woking  
 Surrey, GU24 0BP

© Crown copyright. All rights reserved  
 www.aal.co.uk

Details	
Plotting in AutoCAD made as follows	
Drawn By	Scale
EIS-001	1:500
Date	22/02/2010
File / Pathname / Project / Drawing No.	

REV  
 No.

www.alligned-assets.co.uk





## Proposed Amendments to Parking Restrictions Brewery Road, Milton Regis

A request has been received from two local Councillors for amendments to be made to the existing parking restrictions in the vicinity of Milton Court Primary School in Brewery Road, Milton Regis.

To alleviate some of the parking problems experienced during school drop off and collection times, it is proposed to extend the existing School Keep Clear Markings by approximately 9 metres to a point opposite the junction of Cooks Lane. It is also proposed to install double yellow lines on the corners of Cooks Lane and Brewery Road to protect the junction from parked vehicles and improve the sightlines for vehicles.

If you support or object to the proposal please complete the reply slip below and return to the Borough Council in the pre-paid envelope provided, before Friday 21<sup>st</sup> May 2010. A space has also been provided to allow you to add any further comments you may have.

---

### Proposed Amendments to Parking Restrictions – Brewery Road, Milton Regis

Please tick one of the following boxes

I Support the proposal to amend parking restrictions as shown above
  I Object to the proposal

Name & Address	Comments

The information supplied will only be used in conjunction with this proposal, and used for geographical analysis purposes only



Plan of proposed restrictions

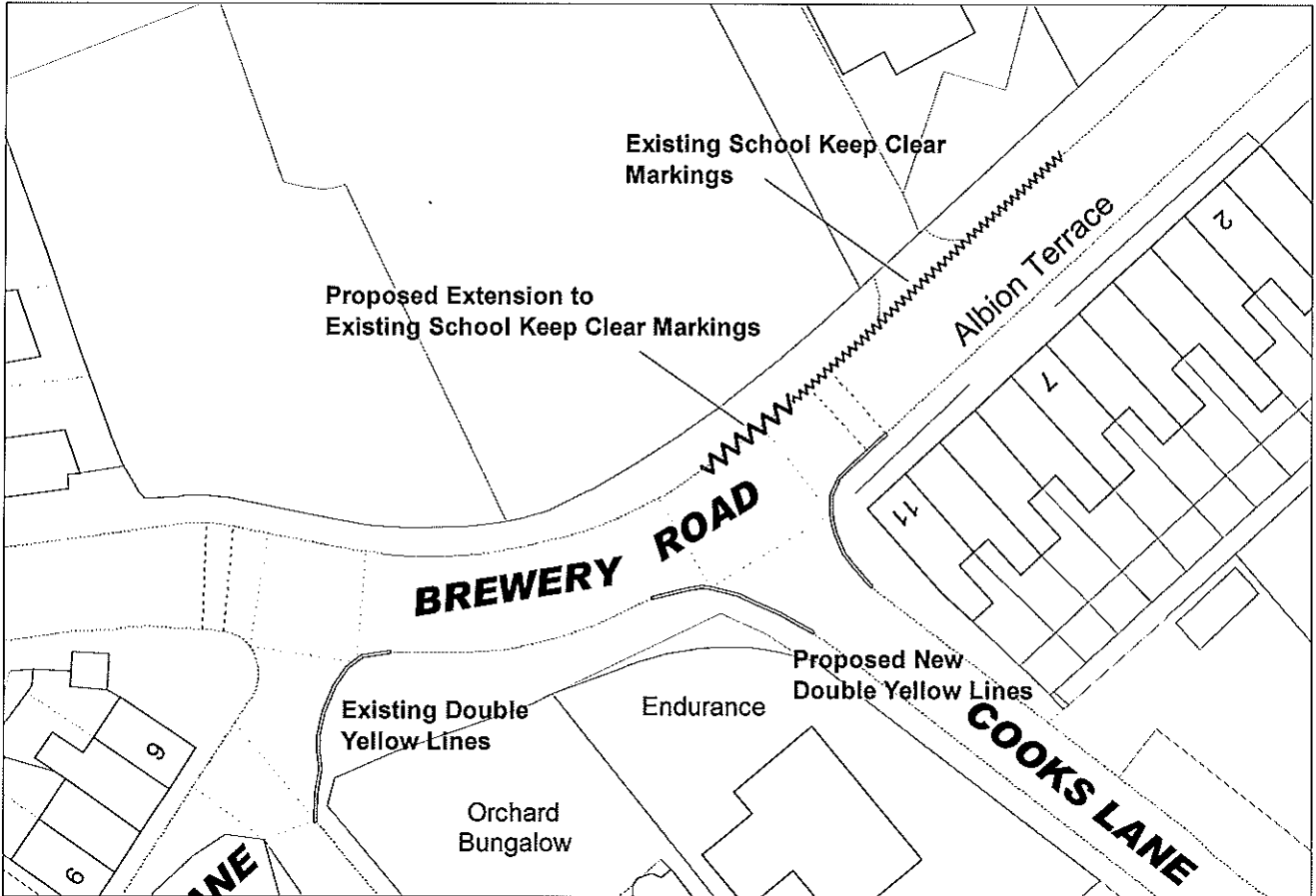

ADDRESS BLOCK



## Proposed Amendments to Parking Restrictions Conyer Road, Barrow Green – Third Consultation

As you are no doubt aware, the issue of proposed amendments to the parking restrictions in Conyer Road, Barrow Green, has been the subject of much debate, two previous consultations and a public meeting. A request has now been received from the Parish Council to consult with residents on their proposals as detailed in Plan 'A' on the reverse of this letter. In addition to this, the Borough Council has prepared proposals detailed in Plan 'B' following comments made at the public meeting. I would be most grateful to receive your views on both proposals, so that all comments can be reported back to the Joint Transportation Board for further consideration.

If you support or object to either proposal please complete the reply slip below and return to the Borough Council in the pre-paid envelope provided, before Friday 21<sup>st</sup> May 2010. A space has also been provided to allow you to add any further comments you may have.

Many thanks for your continued assistance in this matter.

### Proposed Amendments to Waiting Restrictions – Conyer Road, Barrow Green Third Consultation

Please tick one of the following boxes for each plan

I Support proposals detailed in Plan A       I Object to the proposal in Plan A

I Support proposals detailed in Plan B       I Object to the proposal in Plan B

Name & Address	Comments

The information supplied will only be used in conjunction with this proposal, and used for geographical analysis purposes only



Plan 'A' – Teynham Parish Council Proposals

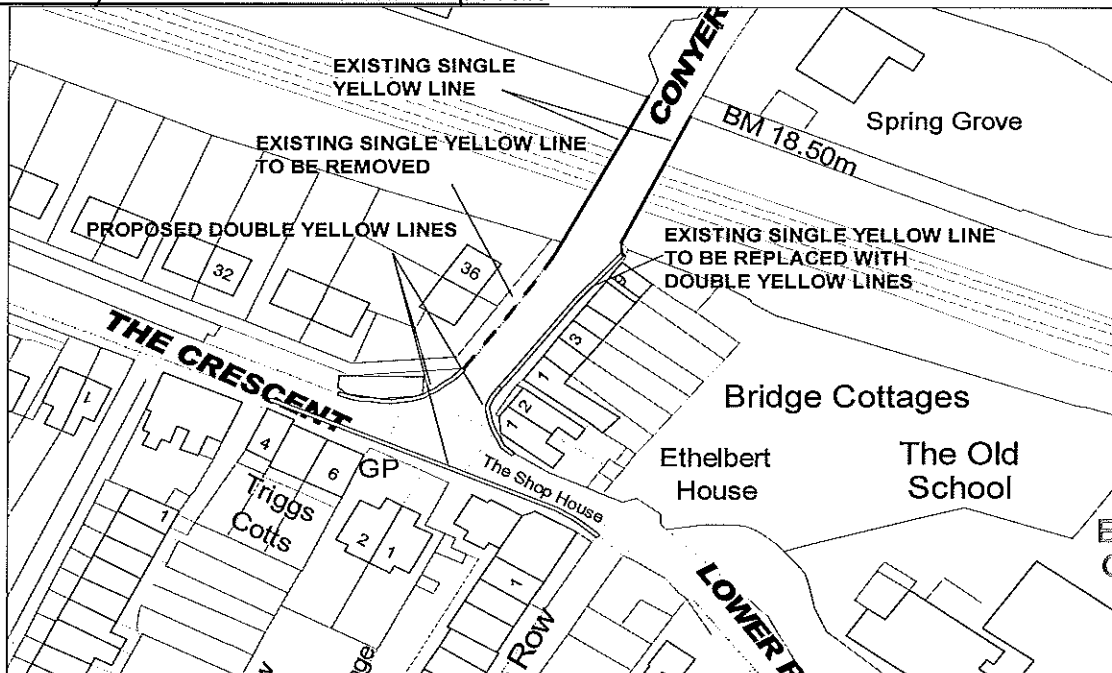

Plan 'B' – Swale Borough Council Proposals

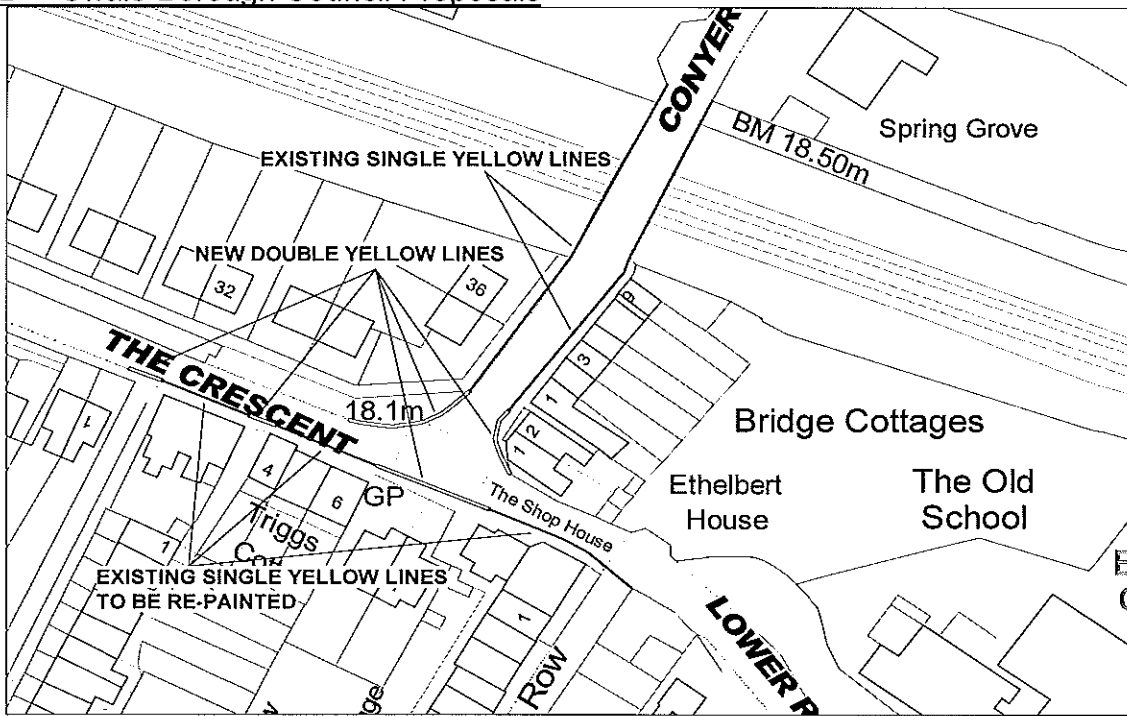

ADDRESS BLOCK

PROPOSED SCHOOL KEEP CLEAR MARKINGS – BELLEVUE ROAD, MINSTER

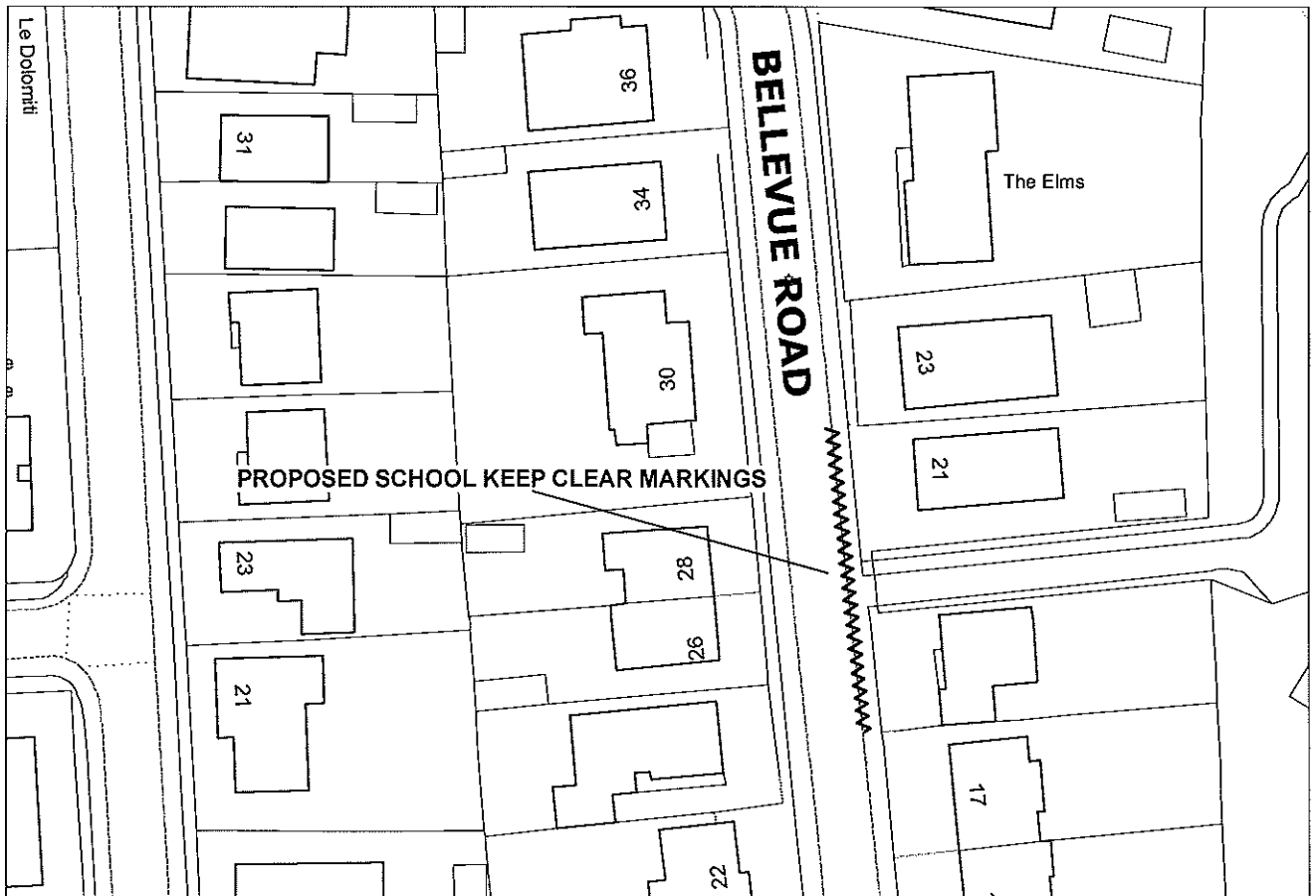

PROPOSED SINGLE YELLOW LINE – KEY STREET LAYBY, SITTINGBOURNE

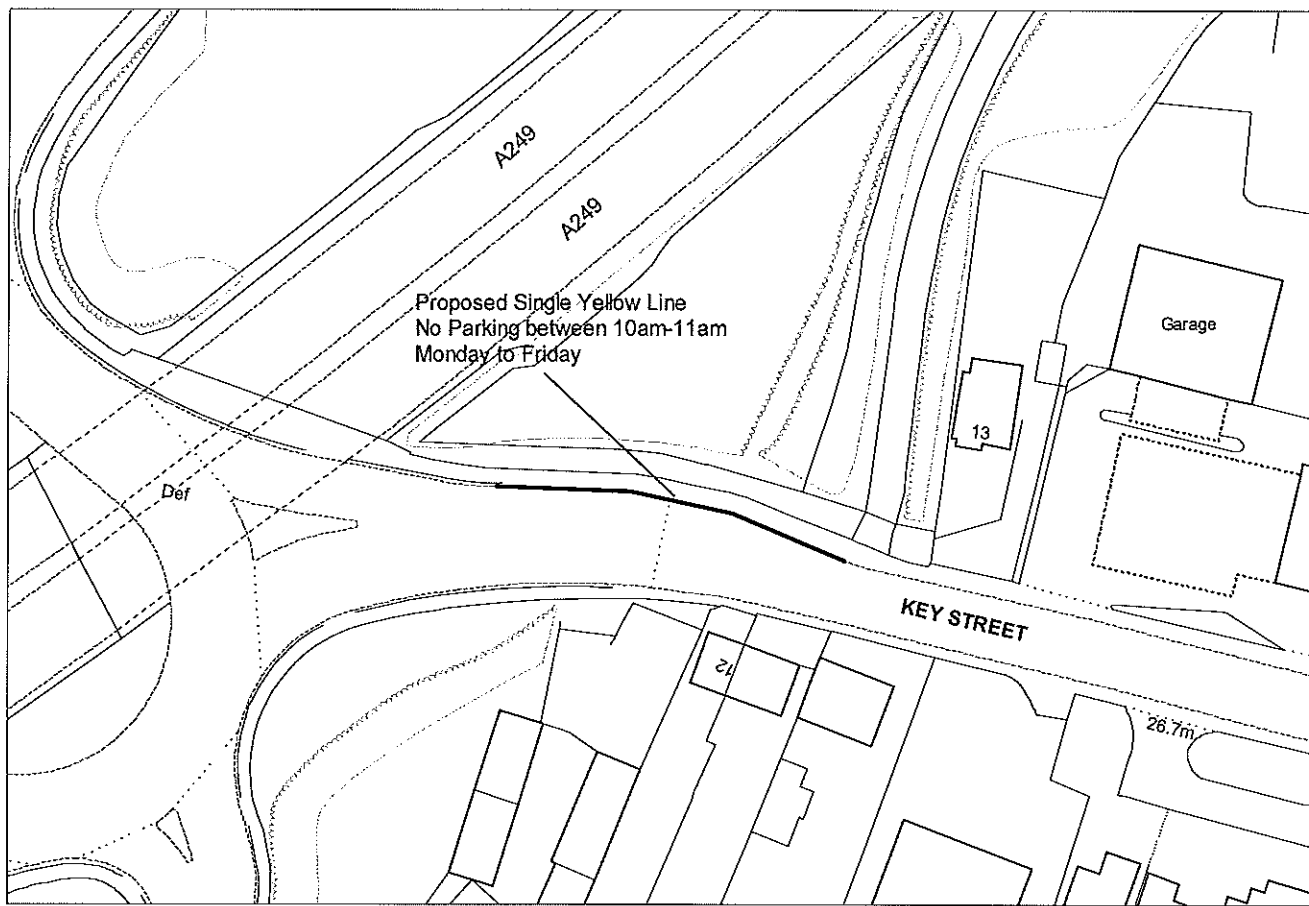



## Proposed Single Yellow Lines Preston Avenue, Faversham

A petition has been received from 13 residents of Preston Avenue in Faversham for Single Yellow Lines to be installed with a one hour parking restriction between 10am and 11am Monday to Friday.

These restrictions have been suggested to tackle commuter parking problems in Preston Avenue by restricting parking for one hour during the day to prevent all day parking, and it is proposed to install these lines on both sides of the road from the junction with the A2 approximately to the boundary of No.26/28 Preston Avenue.

If you support or object to the proposal please complete the reply slip below and return to the Borough Council in the pre-paid envelope provided, before Friday 21<sup>st</sup> May 2010. A space has also been provided to allow you to add any further comments you may have.

---

### Proposed Single Yellow Lines – Preston Avenue, Faversham

Please tick one of the following boxes

I Support the proposal to install single yellow lines
  I Object to the proposal

Name & Address	Comments

The information supplied will only be used in conjunction with this proposal, and used for geographical analysis purposes only

Plan of proposed restrictions



ADDRESS BLOCK